

ACSF-329-FL

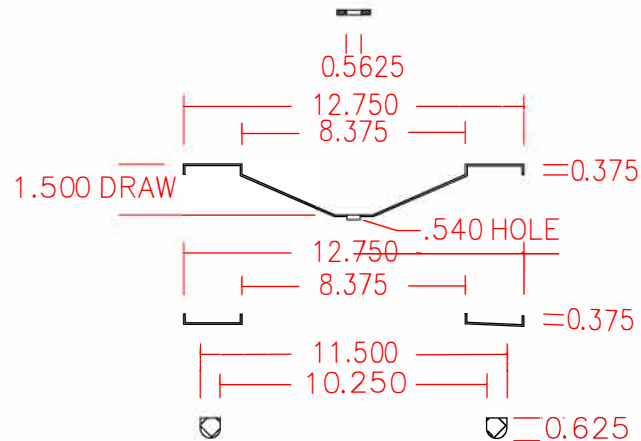

CONSTRUCTION:

ELECTROPLATED GALVANIZED CLOSED END CAP W/ BOLT HOLE
 ELECTROPLATED GALVANIZED OPEN END CAP
 G- 90 GALVANIZED EXPANDED METAL INNER CORE
 100 SQUARE FEET SPUNBONDED POLYESTER MEDIA
 TWO POLYESTER STRAPS GLUED TO THE PLEAT PACK
 EPDM RUBBER SEALING GASKET APPLIED TO ONE OPEN END CAP
 URETHANE SEALANT APPLIED TO BOTH ENDS
 PACKAGED ONE PER CARTON
 WEIGHT: 13 POUNDS

EFFICIENCY: (PER ASHRAE 52.2)

TEST FLOW RATE: 750 CFM
 INITIAL RESISTANCE: 0.74 INCHES W.G.
 FINAL RESISTANCE: 4.00 INCHES W.G.
 E1 (%) COMPOSITE MINIMUM AVERAGE EFFICIENCY 0.30 – 1.00 MICRON: >20%
 E2 (%) COMPOSITE MINIMUM AVERAGE EFFICIENCY 1.0 – 3.0 MICRON: >65%
 E3 (%) COMPOSITE MINIMUM AVERAGE EFFICIENCY 3.0 – 10.0 MICRON: >85%
 MINIMUM EFFICIENCY REPORTING VALUE: MERV 11 @ 750 CFM

